



Lunch
Sponsored By:



Navistar & Beltway Companies

Commercial Transportation Leaders



- **Navistar (NAV)** is a leading U.S. manufacturer of commercial trucks, buses, diesel engines and military vehicles with annual sales of more than \$15B
- Company brands include:
 - **International**® commercial and military trucks
 - **MaxxForce**® diesel engines
 - **IC** school and commercial buses
 - **Monaco**®, **Holiday Rambler**®
 - **Safari**®, **Beaver**® and **R-Vision**® RVs
 - **Workhorse**® brand chassis
- **Beltway Companies** is the market share leader for the sales, parts and service of commercial trucks in Maryland. We operate 6 full service facilities and were the **ATD Truck Dealer of the Year in 2010**.
- Beltway “Green” Product Lines include:
 - **International** Diesel Electric Hybrid Trucks
 - **ESW Thermacat** (DPF Compliant Products)
 - **ESI** (CNG Engine Conversion System)
 - **Nite System** (No-Idle tractor heating and cooling)
 - **E-Star EV Trucks**
 - **Balquon Zero Emission Electric Yard**

eStar's Mission



eStar: FIRST purpose-built electric truck in its class that balances needs of environment and needs of businesses



eStar - Made For the Planet...



- Purpose built to be electric, not merely conversion of fossil fuel vehicle
- Earth friendly – zero tailpipe emissions, each eStar saves 10 tons of CO₂ annually from going into the atmosphere
- Near-zero noise pollution
- Recyclability

eStar – Built For City Business...



Business Smart:

- Companies can actively, visibly proclaim sustainability commitment
- Quiet operation means reduced noise pollution
- Best in Class features such as turning radius
- Actual customer demos available
- Lower Cost – Let us show you how
 - Fewer mechanical components, less to repair
 - 20-minute battery cassette exchange gets drivers back on the road
 - Eliminates downtime with lower maintenance checkpoints

Wakarusa, IN Plant



NAVISTAR® Environmental Leadership

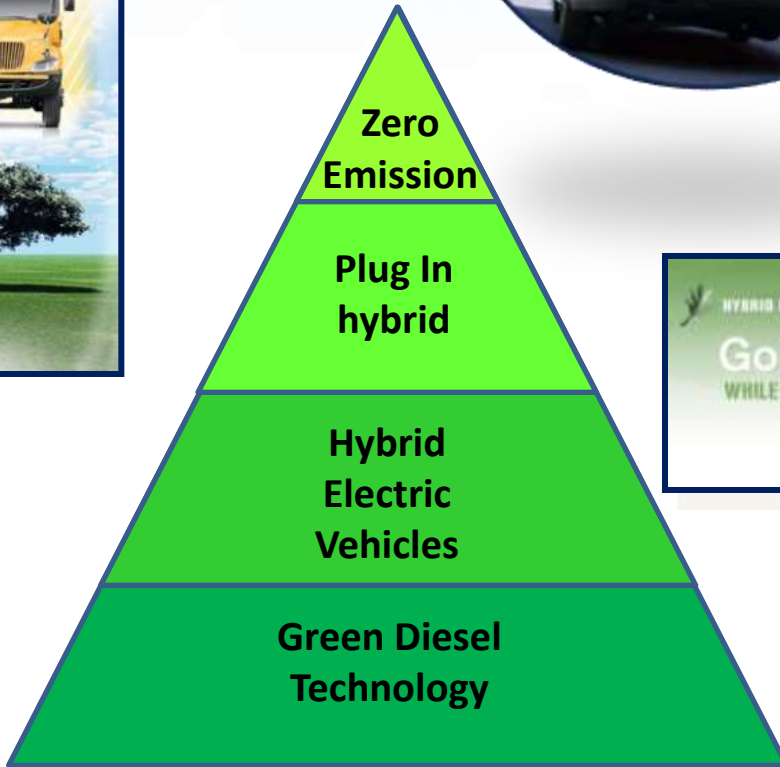

The Only One
The IC Plug-in
Hybrid School Bus

The International logo, a shield with the letter 'I' inside.

HYBRID INNOVATION
Going Green
WHILE SAVING SOME GREEN.

A white and green International truck with a crane attachment, set against a green background with a diamond-shaped logo that says 'INTERNATIONAL'.

President Obama - \$39.2M DOE Announcement @ Estar Plant



eStar Highlights



- Pure plug-in Electric Vehicle
- Purpose built as an EV – not a conversion of conventional vehicle (which has been an issue with competitor’s offerings)
- More than 200 are already delivered by Modec to customers in Europe
- Gross Vehicle Weight – 12,200 lb (Class 3 truck)
- 4,400 lb payload
- 79 kWh battery, 100 mile range
- Charging requirements:
 - 220V split phase outlet
 - 6-8 hours for a complete charge cycle
 - Battery replacement time - 20 minutes

- First recipient of ARRA funding under Transportation Electrification Act to deliver a product to customers
- First commercial EV to achieve EPA, CARB and FMVSS certification
- First production vehicles deployed in LA & Bay Area
- First EV to have Leasing Options- TRAC & Walk Away with Maintenance Options



Product / Technical Overview

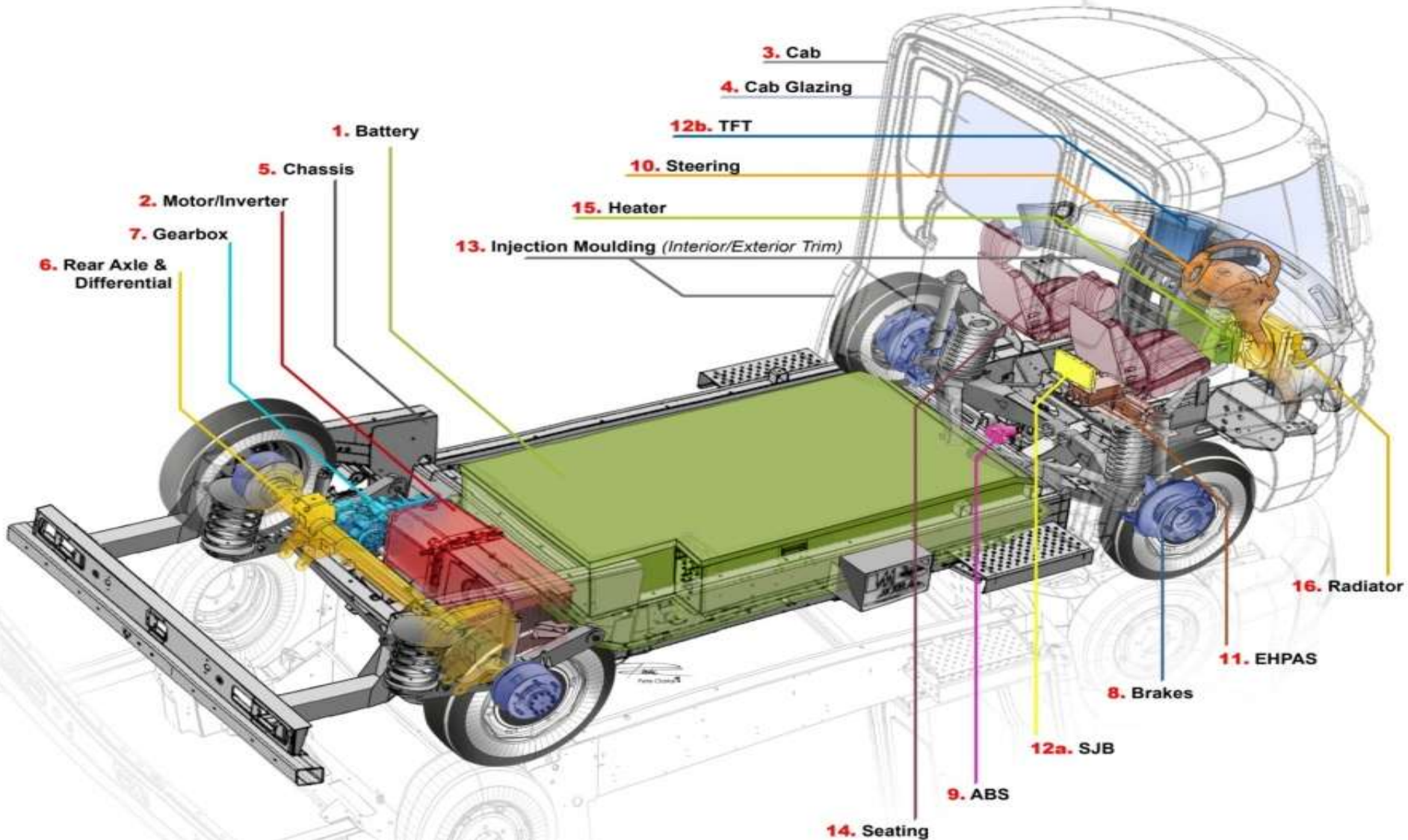

MOTOR

Power	70 kw
Horsepower	102 hp
Torque	221 ft. - lbs

TRANSMISSION

PRND
(Park, Reverse, Neutral, Drive) Clutchless transmission

BATTERY

80kWhr LI-Ion Cassette	Standard
On-Board charger	Standard



PERFORMANCE

CO2 Emissions	Zero
Maximum Speed (governed)	50 mph
Range (up to)	100 miles

BRAKING SYSTEM

Front	4 Piston Callipers - Disk
Rear	10 Inch Duo Servo Drum

ABS
(Anti-lock Braking System) Standard

EBD
(Electronic Braking Distribution) Standard

Regenerative braking Standard

Park brake Hand Apply

WHEELS + TIRES

Wheels	17.5x6 steel-gray
Tires	205/75R17.5

WEIGHT RATINGS + CAPACITIES

Gross Vehicle Weight Rating	12,100 lbs
Payload	4,000 lbs
Front Gross Axle Weight Rating	5,730 lbs
Rear Gross Axle Weight Rating	7,053 lbs

STEERING

Electro-hydraulic power assisted Standard

Turning circle (curb-to-curb) 36 ft

Steering wheel turns lock-to-lock 4.6



SUSPENSION

Front Suspension
Independent coil spring suspension with wishbone style lower control arms, MacPherson struts and anti-roll bar

Rear Suspension
Beam drive axle with trailing arms coil springs and panhard rod

INTERIOR

Electric windows Standard

Electric mirror Standard

i-Pack driver Information display Standard

iButton keyless Ignition Standard

Proximity mirrors Standard

Visibility nearly 180 degrees

Vehicle Charging (J-1772)



Battery charging accomplished using the Model CS-40 charging system.

- The unit operates on either 220/240V single phase, 208V 3-Phase, Wye-Connected voltage or 240V 3-Phase, Delta connected, with center-tap on one leg
- Charge port located curb side behind rear wheel; cannot be driven while the charger is connected
- Commonality with other EV's such as the Leaf & Volt

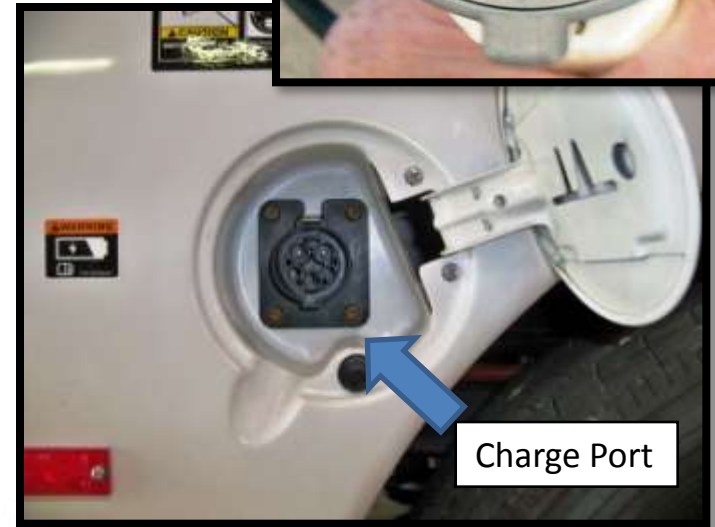

Body Dimensions

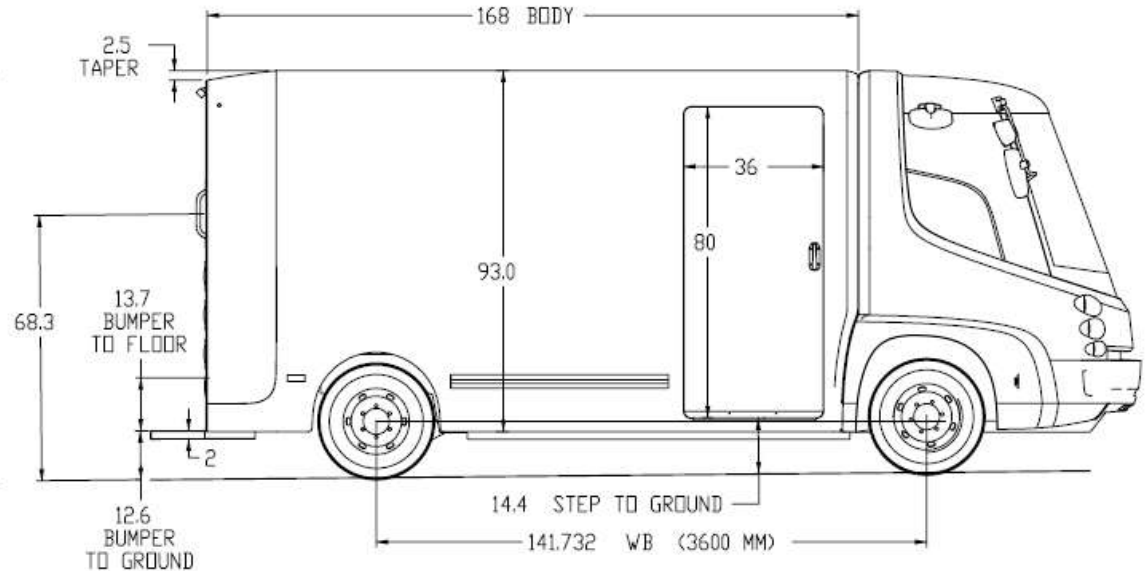
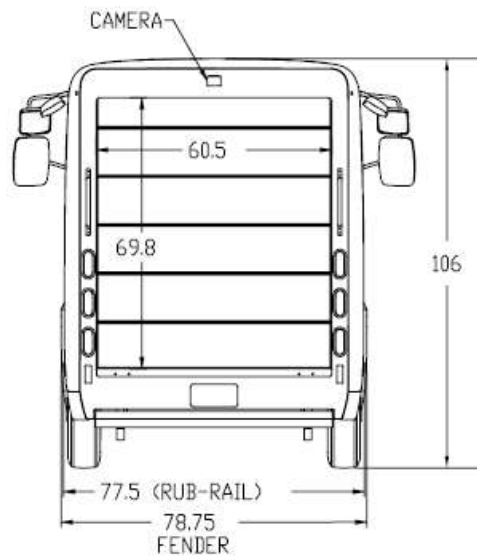
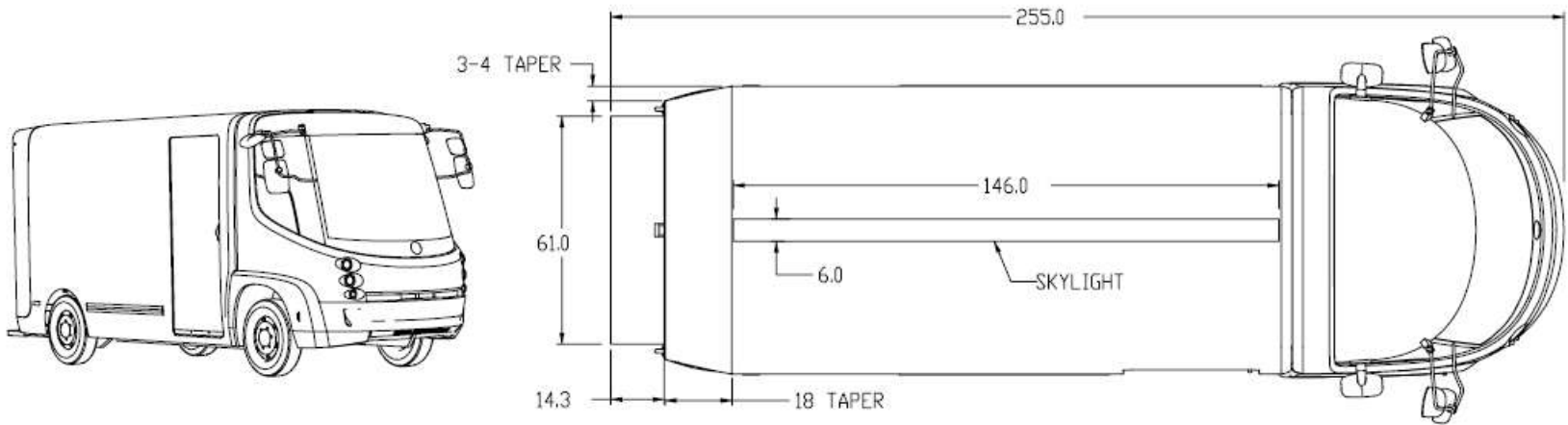

Dimensions



Feature	Dimensions
Overall Vehicle Height	106"
Overall Chassis Width (Between Front wheel fenders)	78.75"
Overall Body Width (Between Rubrails)	77.5"
Overall Vehicle Length (Bumper to Bumper)	254"
Cargo Capacity (Excluding Vestibule Space)	417 sq. ft.
Interior Cargo Area Height	78" under posts
Interior Cargo Area Width	74"
Cargo Area Floor Length	154"

Dimensions



Feature	Dimensions
Rear Roll Up Door Opening	
Opening Width	60.5"
Opening Height	70"
Sliding Side Door Opening	
Opening Width	30"
Opening Height	80"
Inset Step Height	10.5"
Rear Bumper Height (at top of bumper)	12.5"
Floor height	26"



Sam Eitel

Sales/Marketing Administrator

Beltway Companies

M: (301) 418-2111

E: sam.eitel@beltwaycompanies.com

W: www.beltwaycompanies.com



Thank you.